

I M

⊗ *Electronisk tænding er nr. 147-1567-097*
Bege typer tænding går om hverandre. Vi sælger
stift og condenser, men ellers skiftes vanlig coil med
electronic.

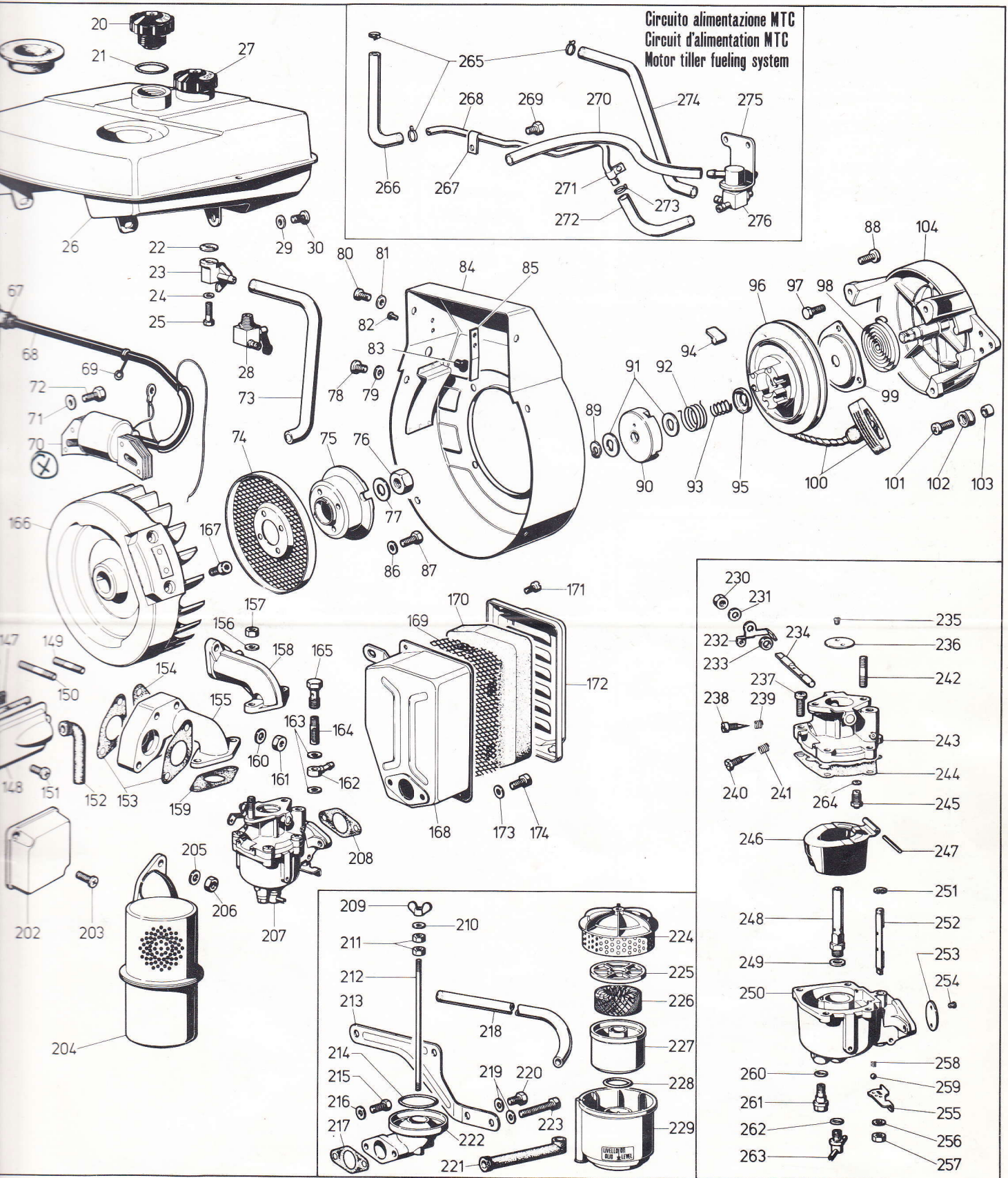

REPLACE PARTS FOR ENGINES: STANDARD, WITH REWIND STARTER, WITH
 L BATH AIR CLEANER.
 FOR SPECIAL APPLICATIONS SEE MASTER CATALOG AT SERVICE GEN-
 R.

ERSATZTEILE FÜR MOTOREN: STANDARD, MIT REVERSIERSTARTER, MIT
 ÖLBADLUFTFILTER.
 FÜR SONDERANFERTIGUNGEN SIEHE ERSATZTEILKATALOG BEI SERVICE
 WERKSTATTEN.

Ricambi motorino SJCE

Pièces détachées pour démarr. SJCE

Spare parts for SJCE electr. start. mot.

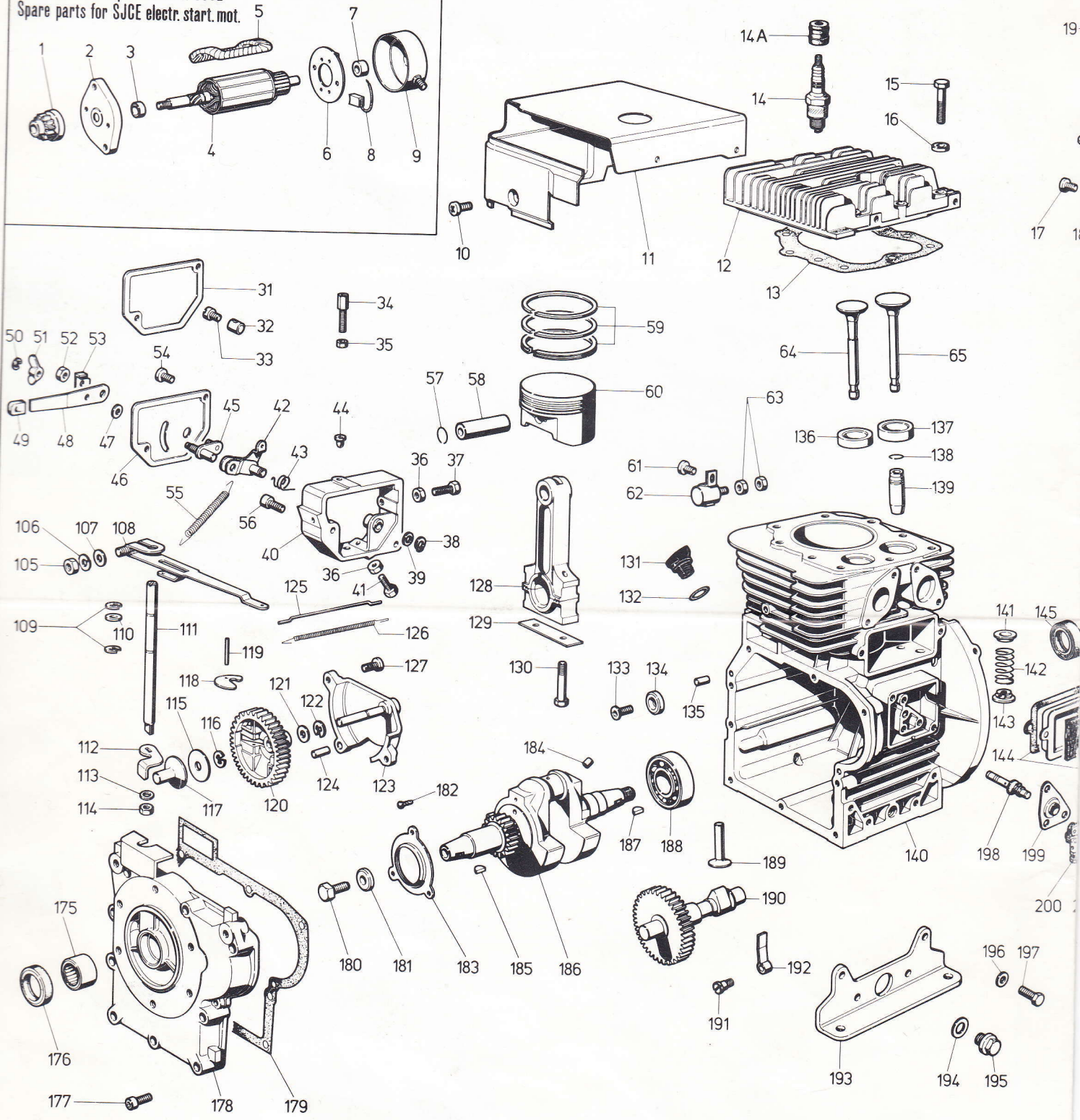

RICAMBI PER MOTORI: STANDARD, CON AUTOAVVOLGENTE, CON FILTRO A BAGNO D'OLIO.
 PER APPLICAZIONI SPECIALI CONSULTARE IL CATALOGO PRESSO I CENTRI ASSISTENZA E RICAMBI.

PIECES POUR MOTEURS: STANDARD, AVEC LANCEUR A CABLE, AVEC FILTRE A AIR A BAIN D'HUILE.
 POUR LES ADAPTATIONS CONSULTER LE CATALOGUE AUPRES DES AGENTS SERVICE.

FIG. No.	MATRICOLA PART No.	PEZZI PIECES	NOTE REMARKS	FIG. No.	MATRICOLA PART No.	PEZZI PIECES	NOTE REMARKS
52	9.3240.04			108	147.5204.22		
53	90.6330.57			109	9.1165.06		
54	9.9790.28			110	9.7626.59		
55	147.5655.47			111	147.6141.63		
56	9.9730.10			112	147.5204.06		
57	9.1261.16			113	9.7565.04		
58	47.8480.02			114	9.3240.08		M 6 X 1
59	147.8210.96			115	90.3430.55		
	147.8210.97			116	9.1165.10		
	147.8210.98			117	147.7200.64		
	150.8210.77			118	*	6	
	150.8210.78			119	*	2	
	150.8210.79			120	*		
	158.8210.99			120C	147.4910.31		DAFIG.118A120
	158.8211.01			121	9.7260.17		
	158.8211.02			122	9.1165.10		
60C	147.6502.80			123	147.8780.10		
	147.6502.82			123C	147.7362.75		DAFIG.115A123
	147.6502.83			124	9.6130.50		
	150.6502.15			125	90.2183.31		
	150.6502.16			126	70.5800.72		
	150.6502.17			127	9.9790.47	2	M 6 X 1
	158.6502.81			128C	147.1526.26		DAFIG.128A130
	158.6502.84				147.1526.27		- 0,25
	158.6502.85				147.1526.28		- 0,50
	*			128	*		
60	*			129	90.6330.55		
61	9.9790.39			130	9.1760.30	2	M 6 X 1
62	147.2522.10			131	90.9032.16		
63	9.3240.03			132	9.1200.03		
64	90.9685.22			133	9.9800.51		M 8 X 1,25
65	90.9652.16			134	147.7670.93		
66	70.1450.01			135	90.8460.83	2	
67	1.5400.07			136	90.8000.33		
68	*			137	90.8000.34		
68C	147.2187.02			138	90.1160.05	2	
69	147.2471.13			139	90.4845.28	2	
70C	147.1567.35			140C	147.1514.01		DAFIG.135A140
70	*						IM 250
71	9.7625.07						IM 300
72	9.1760.06	2			155.1514.02		IM 350
73	147.9375.99	2	M 6 X 1	140	158.1513.99		
74	147.5096.13			141	*		
75	147.6961.14			142	90.6400.29	2	
76	9.3260.55			143	90.5755.36	2	
77	90.7530.18			144	90.6400.28	2	
78	9.9790.39			145	90.4680.39		
79	271.7500.18	4	M 6 X 1	146	9.1213.02		
80	9.9790.39	4		147	90.7950.65		
81	271.7500.18	2	M 6 X 1	148	90.5976.01		
82	9.7481.25	2		149	90.2690.46		
83	70.7195.03	2			9.6760.06	2	M 6 X 1
84C	147.2568.53						BENZ./GASOL.
84	*						PETR./KEROS.
85	147.5640.10			150	9.6760.13	2	M 6 X 1
86	9.7555.04				9.6760.06	2	M 6 X 1
87	9.1760.06	4			9.6760.15	2	BENZ./GASOL.
88	9.9790.39	4	M 6 X 1	151	9.9790.39	2	PETR./KEROS.
89	9.1240.04	4	M 6 X 1	152	147.9580.18		M 6 X 1
90	147.2136.07			153	158.4501.18		
91	147.3410.54			154	158.4501.19		BENZ./GASOL.
92	147.5680.64			155	89.9708.02		
93	90.5725.35			156	9.7555.04	2	PETR./KEROS.
94	90.6366.04			157	9.3240.08	2	M 6 X 1
95	147.6400.41	3		158	158.2942.58		BENZ./GASOL.
96	147.7100.53			159	158.4470.13		
97	9.1750.01			160	9.7565.04	2	
98	147.5801.20	3	M 4 X 0,7	161	9.3240.08	2	M 6 X 1
99	147.7950.98			162C	147.4896.13		DAFIG.162A165
100	90.4055.05			162	147.7270.82		
101	9.9790.86	2	M 6 X 1	163	9.4350.05		
102	147.2162.16	2		164	147.3730.34		
103	147.1971.04	2		165	147.1901.08		M 10 X 1,25
104	147.7950.97			166C	147.9884.90		DAFIG.166A167
104C	147.1471.11			166	*		
105	9.3240.04			167	9.9730.24	2	M 8 X 1,25
106	9.7555.03			168C	147.3702.75		DAFIG.168A172
107	9.7625.05			168	147.7870.11		
				169	147.3930.60		

bruk 5801.021



intermotor

FIG. NO.	MATRICOLA PART NO.	PEZZI PIECES	NOTE REMARKS	FIG. NO.	MATRICOLA PART NO.	PEZZI PIECES	NOTE REMARKS
				234C	999.6100.27		IM 350
				235	9.9810.10	2	M 3 X 0,5
				236	999.3605.18		IM 250/300
170	147.5496.62				158.3605.30		IM 350
171	9.9760.11	2		237	9.9790.91	4	M 5 X 0,8
172	147.2605.13			238	999.9850.37		
173	9.7565.04	2		239	999.5780.11		
174	9.1760.03	2	M 6 X 1	240	90.9850.51		
175	9.3030.28			241	70.5780.06		
176	9.1213.56			242	9.6760.34	2	M 6 X 1
177	9.9732.60	9	M 8 X 1,25	243	147.2751.98		IM 250/300
178	147.6647.06				158.2750.100		IM 350
179	147.4601.29			244	147.4431.62		
180	9.1770.39		M 8 X 1,25	245	90.7996.11		
181	9.7625.60			246	90.4105.10		
182	9.7481.24	3		247	999.6110.42		
183	147.2194.14			248	999.3588.10		
184	90.9000.27			249	999.4530.07		
185	9.2280.47			250	147.2825.29		
186C	147.1052.29		DAFIG.182A187	251	9.1165.10		
186	*			252	*		
187	9.2280.44			252C	999.6100.12		DAFIG.251A257
188	9.3001.09						IM 250
189	90.7215.29	2			999.6100.21		IM 300
190	147.1011.55		IM 250		999.6100.22		IM 350
	158.1011.71		IM 300/350	253	90.3605.26		IM 250
191	147.6231.35				155.3605.28		IM 300
192	147.5170.10				158.3605.29		IM 350
193	90.6427.06	2		254	9.9810.10	2	M 3 X 0,5
194	9.4350.06	2		255	90.5195.10		
195	90.8980.10	2		256	9.7555.03		
196	9.7565.07	8		257	9.3240.04		M 5 X 0,8
197	9.1770.02	8	M 8 X 1,25	258	999.5695.07		
198	147.7200.67		DAFIG.198A199	259	9.8245.03		
199	147.1301.74			260	9.1200.52		
200	70.5040.06			261	*		Ø 0,50
201	9.9790.28	3	M 5 X 0,8	261C	999.4125.48		DAFIG.260A261
202	147.2751.77			262	9.1200.01		
203	9.9790.47	2	M 6 X 1	263	*		DAFIG.262A263
204	147.5462.70		STANDARD		147.4126.05		IM250/300(Ø,90)
	147.5462.77		MOTOCOLTIV/ M.TILLER		158.4126.15		IM350(Ø,94)
205	9.7565.04	2		264	90.4690.07		
206	9.3240.09	2	M 6 X 1	265	9.3630.57		
207	147.2151.63		IM 250	266	9375.108		
	155.2151.64		IM 300	267	6193.3617.37		
	158.2151.65		IM 350	268	6040.9375.65		
208	147.4490.36			269	9.1760.01		
209	9.3200.01			270	9375.108		
210	9.7625.05			271	3617.18		
211	9.3240.04		M 5 X 0,8	272	9375.109		
212	150.9245.55			273	9.3630.57		
213	155.8490.76			274	9375.107		
214	9.1200.70			275	6040.8546.37		
215	9.1760.06		M 6 X 1	276	6040.7755.62		
216	9.7565.04			BLOCCO MOTORE/SHORT BLOCK			
217	90.4470.10				1560.63		IM 250
218	147.9375.98				1560.64		IM 300
219	9.7565.04				1560.65		IM 350
220	9.1760.03		M 6 X 1				
221	150.9400.31						
222	150.8740.92						
223	9.1760.61		M 6 X 1				
224	*						
225	*						
226	150.2175.24	2		SERIE GUARNIZIONI/GASKET SET			
227	*				147.8180.57		IM 250/251
228	9.1200.85				155.8180.58		IM 300/301
229	*				158.8180.59		IM 350/351/352/252/302
229C	150.3701.93		DAFIG.224A229	* Non fornito sciolto/Not supplied separately			
	155.3703.04		DAFIG.209A229				
230	9.3240.04		M 5 X 0,8	C Complessivo/Assembly			
231	9.7555.03						
232	999.8510.30						
233	147.1301.83						
234	*						
234C	999.6100.11		DAFIG.231A236 IM 250/300				